

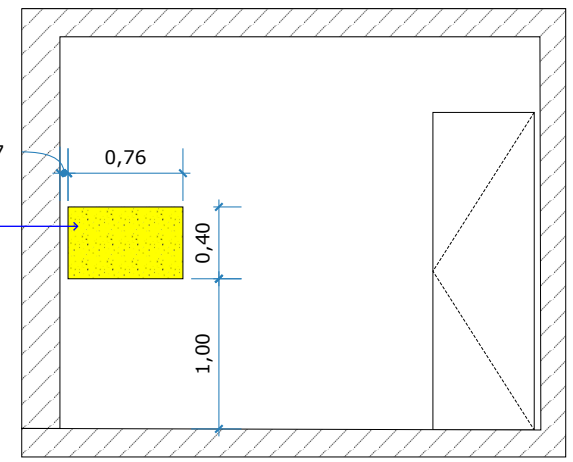

Demolir porta e janela existentes e fazer furo para encaixe da porta

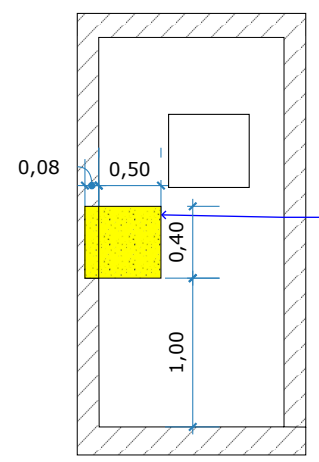
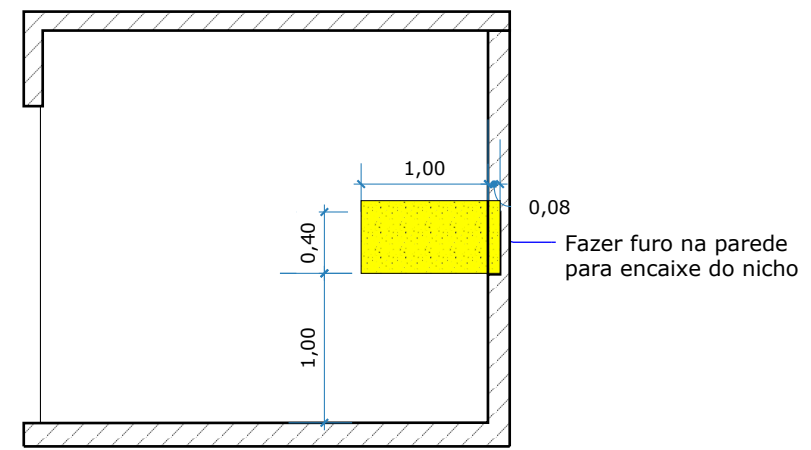
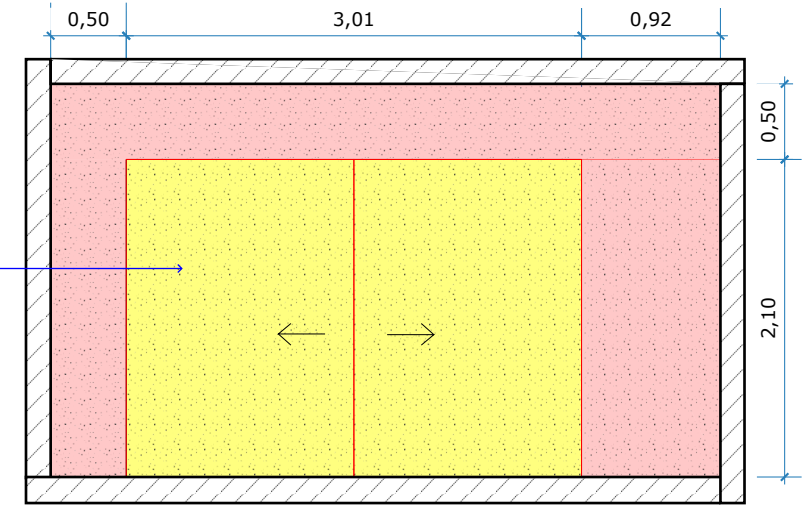

**legenda**

- á construir
- á demolir
- permanece

**Executivo**

**PLANTA DE DEMOLIÇÃO**

Descrição: Planta de demolição

Data: 05/06/ 2020

Escala: 1:75

Prancha: **1 / 1**



1 Planta de layout

Executivo

PLANTA DE LAYOUT

Descrição: Planta de Layout

Data: 05/06/ 2020

Escala:

Prancha:

2/ 1

Urbana Branco 0.60cmX0.60cm  
- Pointer

Portland HD DGR  
0.90cmx0.90cm

Urbana Branco 0.60cmX0.60cm  
- Pointer

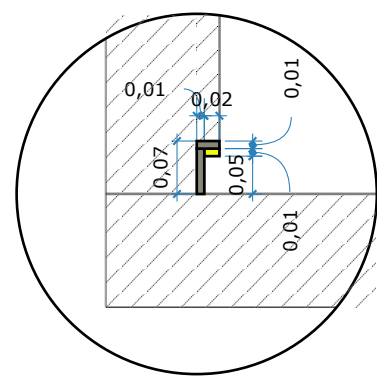

DET 01 - RODAPÉ EMBUTIDO  
ESCALA 1 : 10

- Cantoneira de alumínio
- Fita de LED



1 Planta de paginação de piso  
ESCALA: 1 : 75

## Executivo

## PLANTA DE PAGINAÇÃO DE PISO

Descrição: Planta de paginação de piso

Data: 05/06/ 2020

Escala: 1 : 75

Prancha:

3 / 1

1ª Pedra a ser colocada  
Metrô White Eliane 10X20 cm  
Junta de assentamento 2mm  
Rejunte Epóxi Eliane

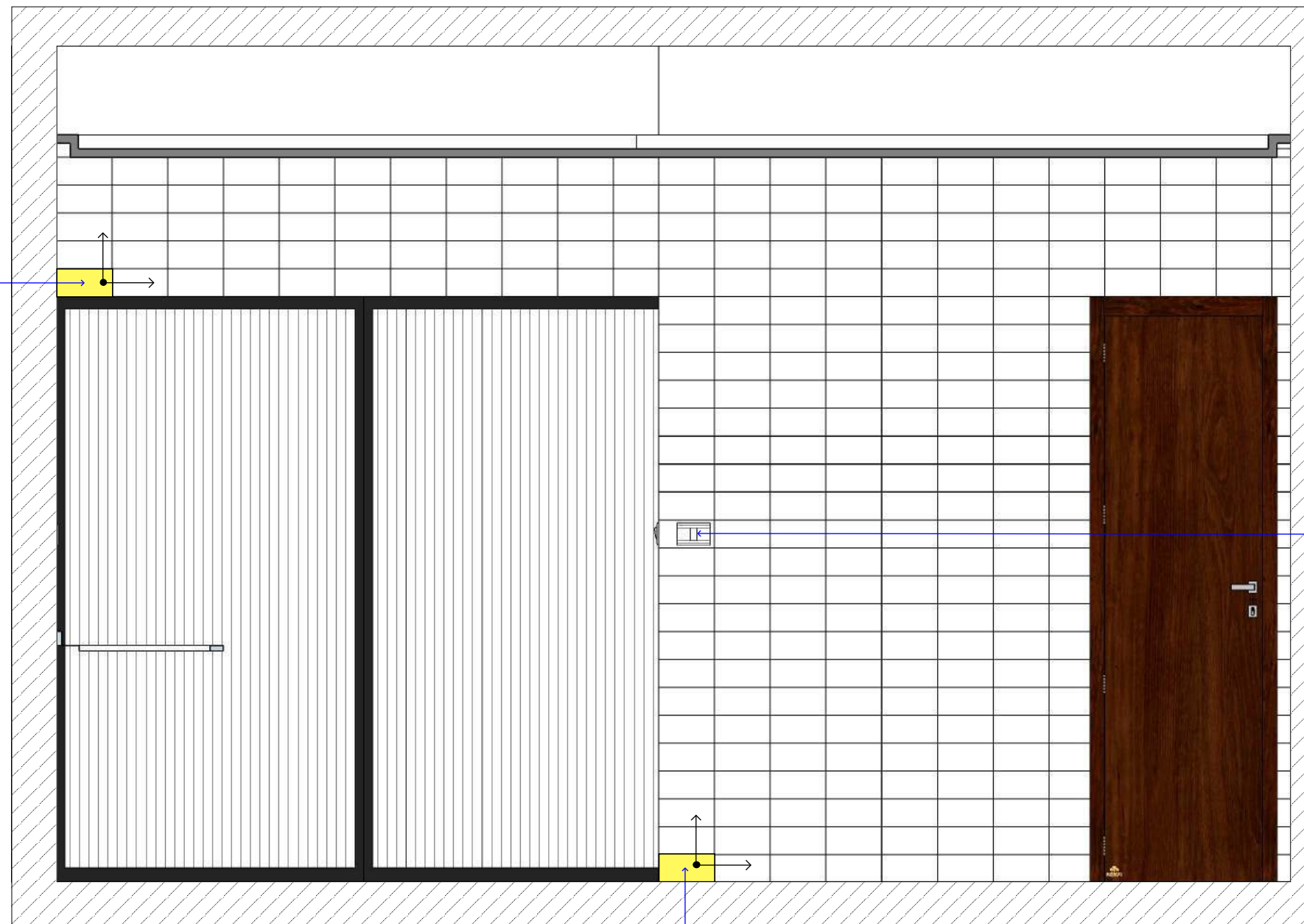

Interruptor simples

1 Vista de paginação  
ESCALA: 1 : 20

1ª Pedra a ser colocada  
Metrô White Eliane 10X20 cm  
Junta de assentamento 2mm  
Rejunte Epóxi Eliane

Executivo

VISTA DE PAGINAÇÃO

Descrição: Vista de paginação

Data: 05/06/ 2020

Escala: 1 : 20

Prancha:

4 / 1

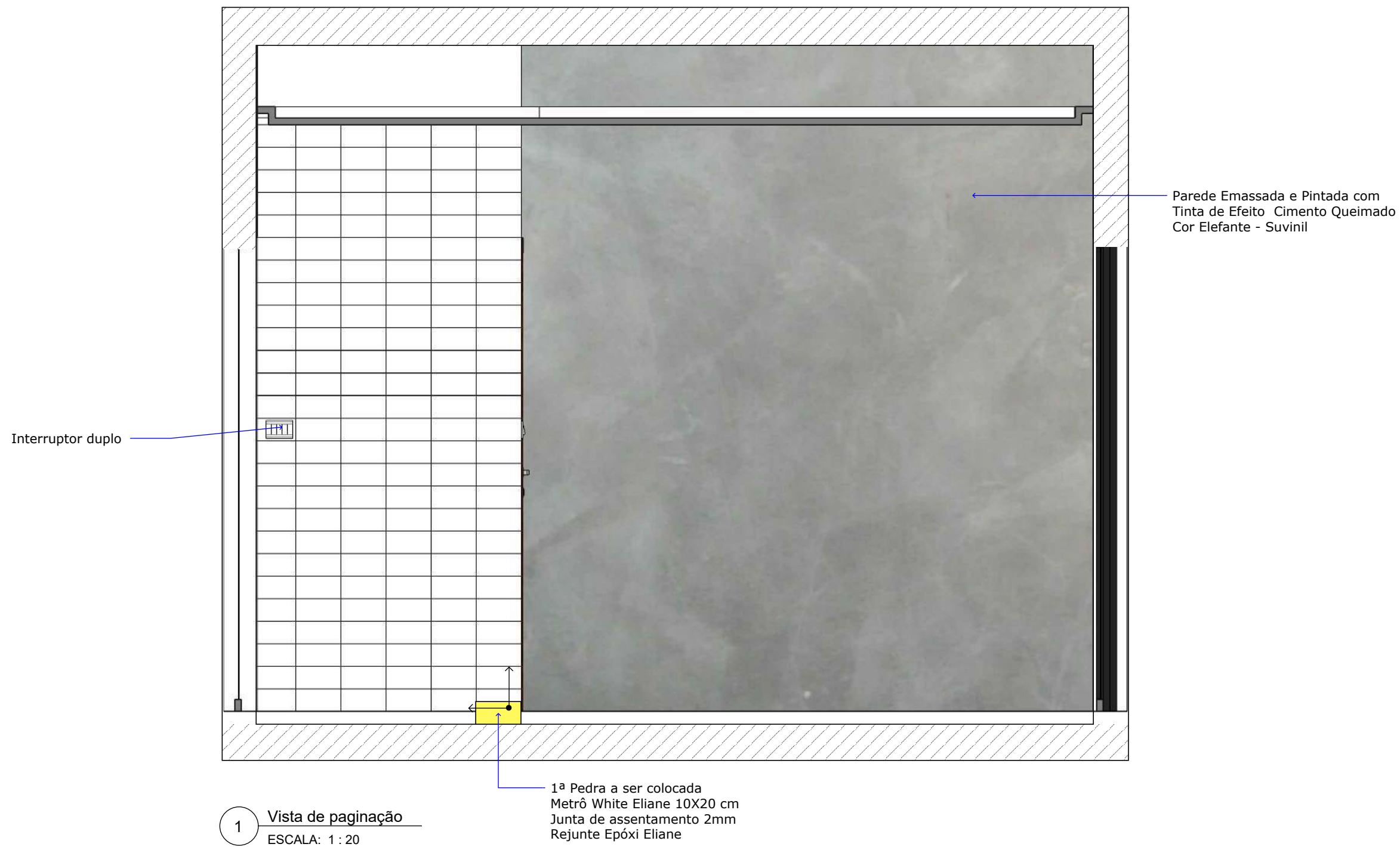

**Executivo**

**VISTA DE PAGINAÇÃO**

Descrição: Vista de paginação

----

----

Data: 05/06/ 2020

Escala: 1 : 20

Prancha:

**5 / 1**

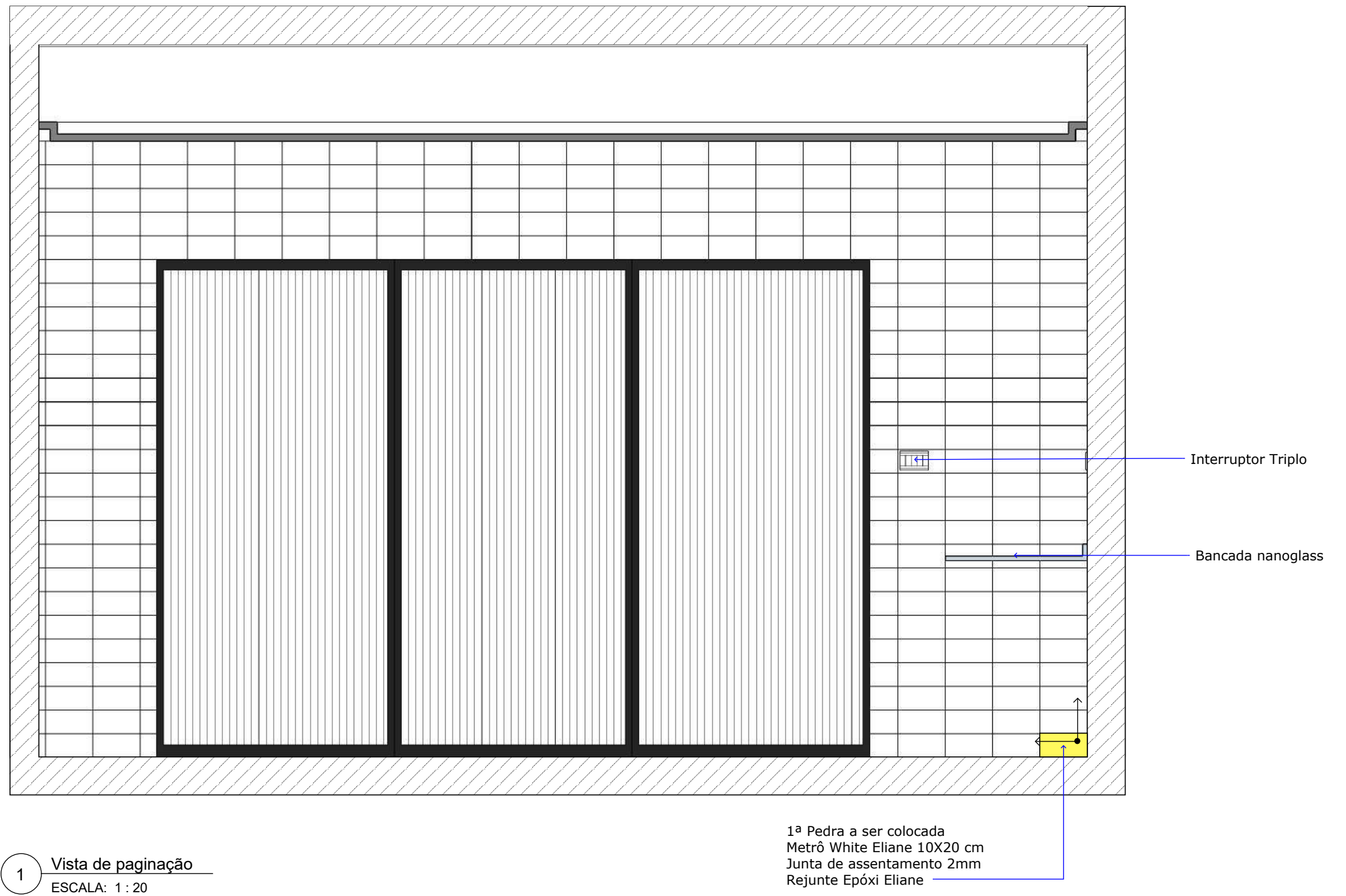

**Executivo**

**VISTA DE PAGINAÇÃO**

Descrição: Vista de Paginação

----

----

Data: 05/06/ 2020

Escala: 1 : 20

Prancha:

**6 / 1**

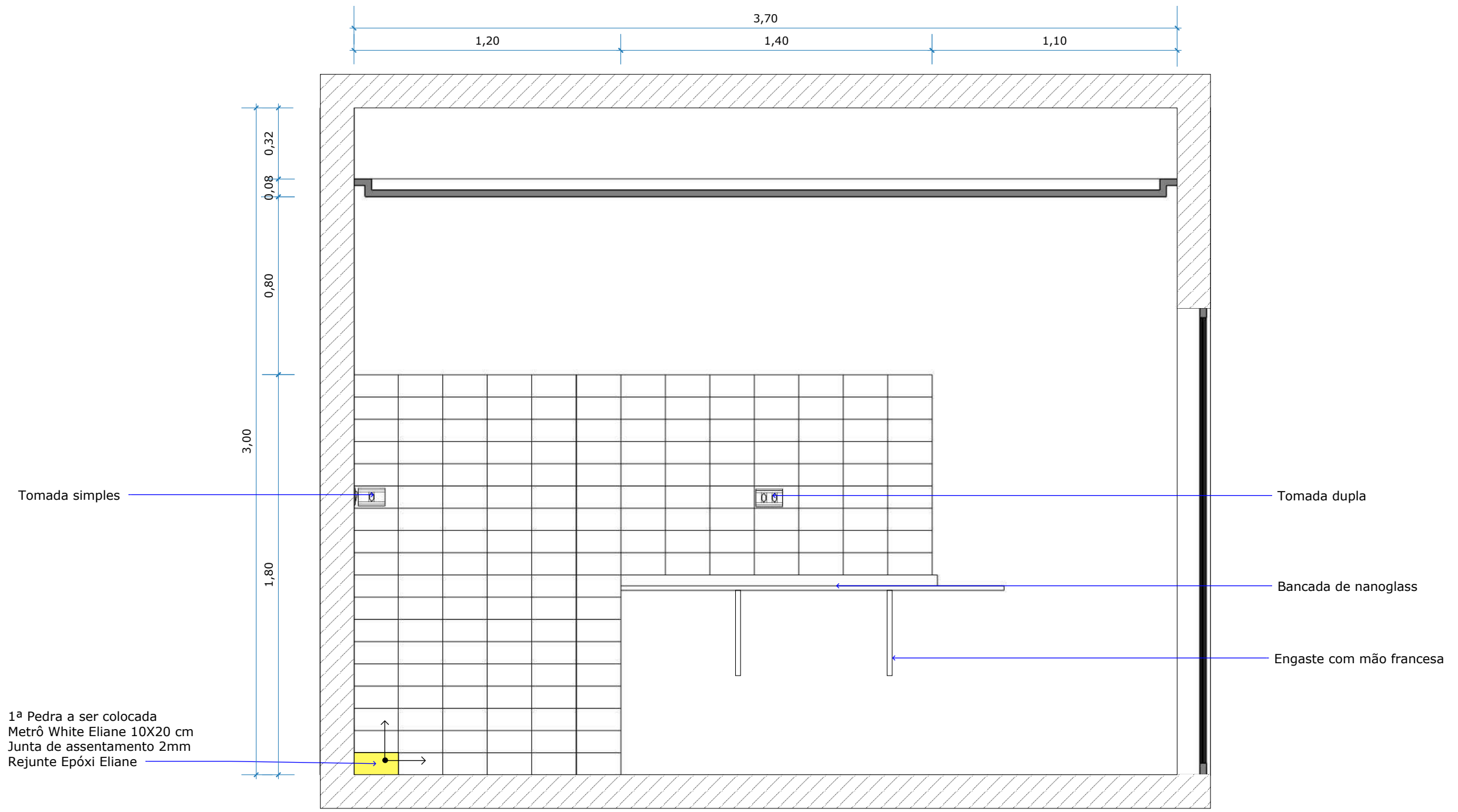

1 Vista de paginação  
ESCALA: 1 : 20

**Executivo**

**VISTA DE PAGINAÇÃO**

Descrição: Vista de Paginaçã

----

----

Data: 05/06/ 2020

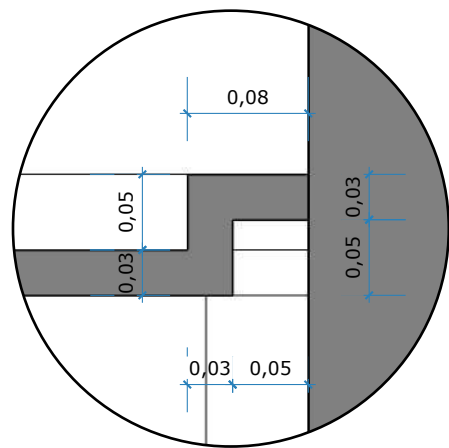
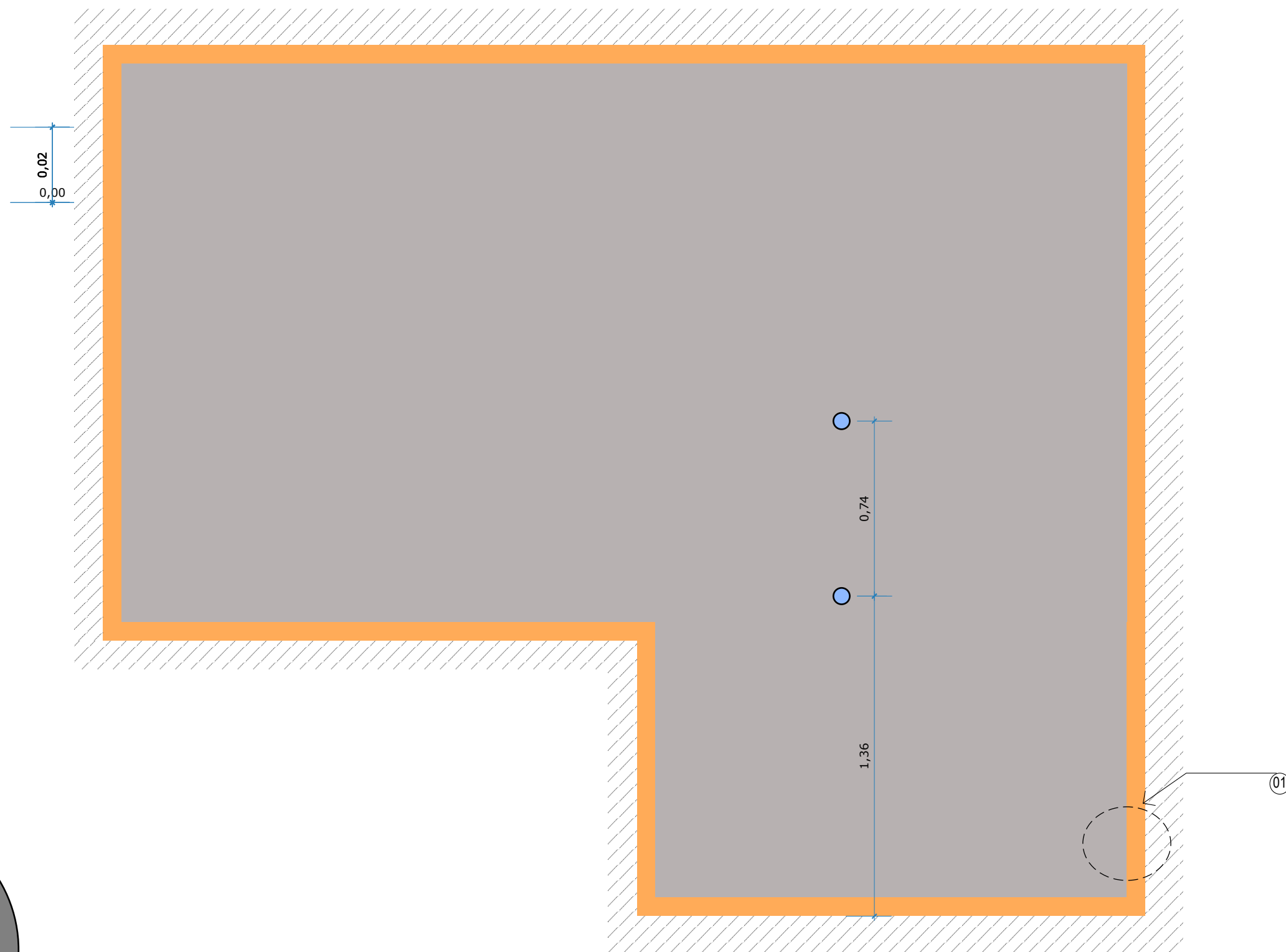

Escala: 1 : 20

Prancha: **7 / 1**



DET 01  
ESCALA 1:5

1 Planta de forro  
ESCALA: 1 : 20

-  JUNTA DE DILATAÇÃO
-  JUNTA DE DILATAÇÃO PD = 2,60M
-  ABERTURA COM 5 CM DE DIÂMETRO

**Executivo**

**PLANTA DE FORRO**

Descrição: Planta de forro

Data: 05/06/ 2020

Escala: 1 : 20

Prancha:

**8 / 1**



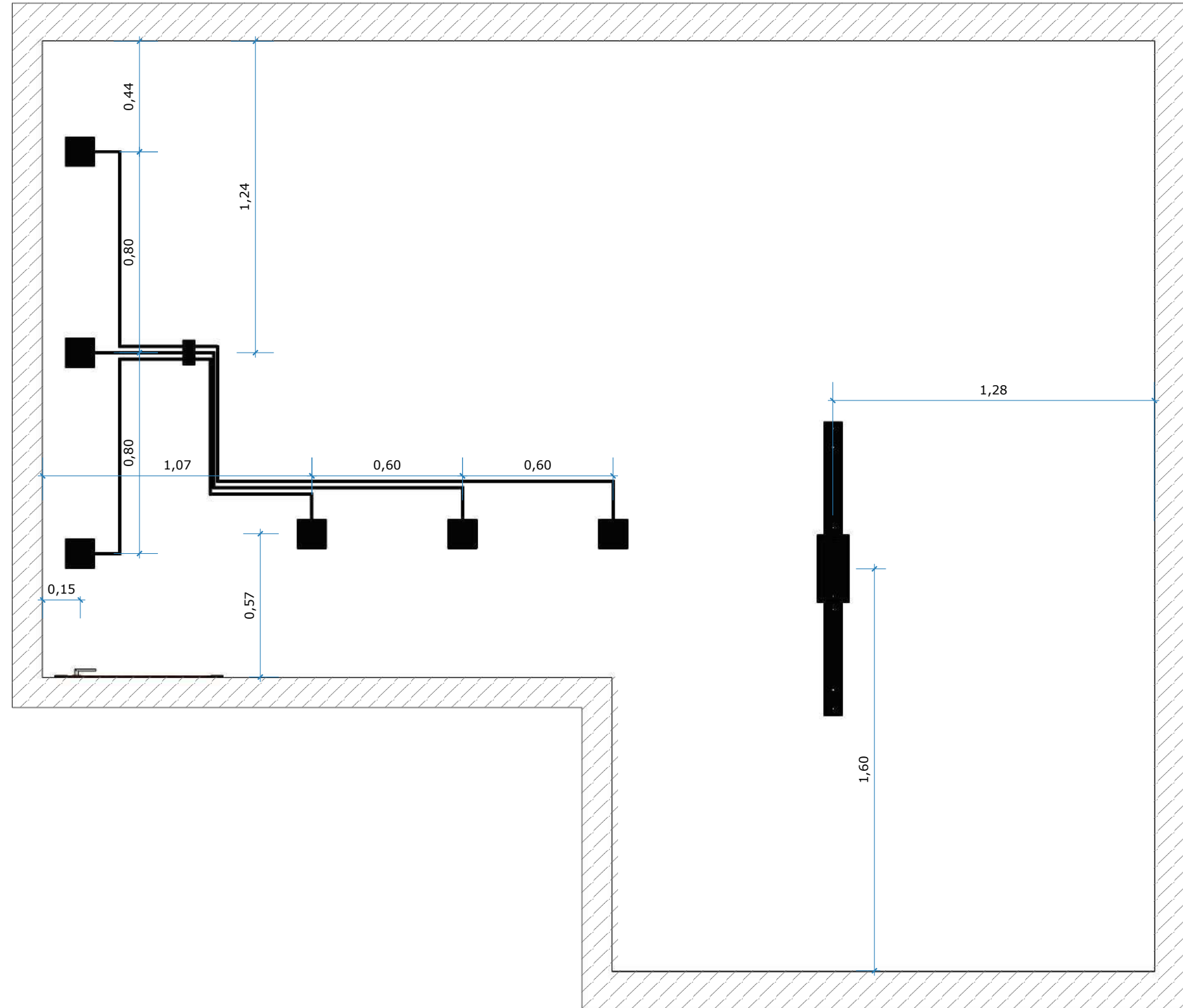

1 Planta de Pontos de Iluminação  
 ESCALA: 1 : 20

■ AR 70 DE SOBREPOR 10,5X11,5X11,5

■ PAR 20 DE SOBREPOR 11X11,8X11,8

▬ PENDENTE LED FILET RETANGULAR/CALHA 3000K  
 QUENTE 23W 110V 106X4CM METAL E ACRÍLICO  
 | BELLA ITALIAV

**Executivo**

PLANTA DE PONTOS DE ILUMINAÇÃO

Descrição: Planta de Pontos de Iluminação

Data: 05/06/ 2020

Escala: 1 : 20

Prancha:

9 / 1

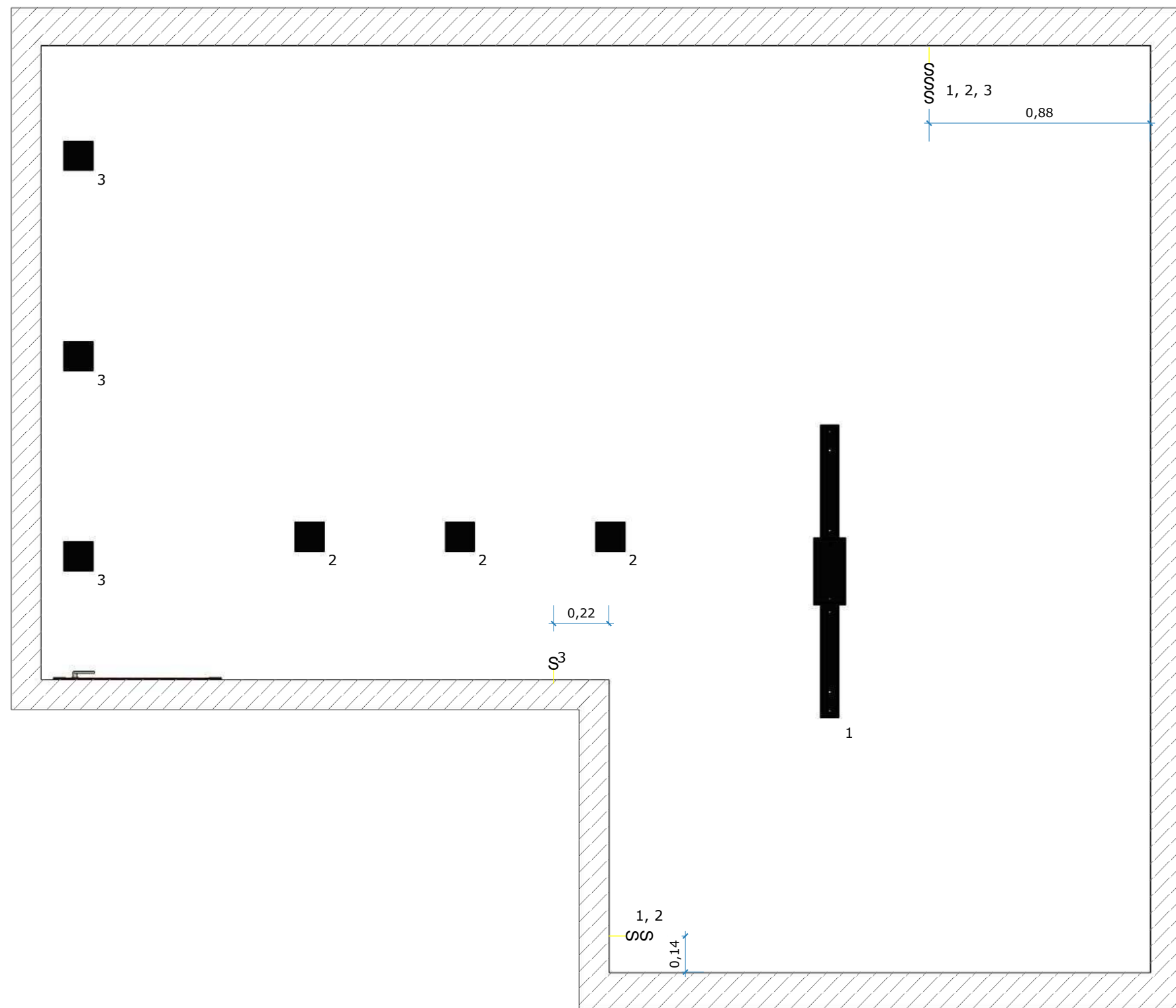

1 Planta de Pontos de Interruptores  
 ESCALA: 1 : 20

| LEGENDA CIRCUITOS |  | LEGENDA PONTOS ELÉTRICOS |   |
|-------------------|--|--------------------------|---|
| 1                 | PENDENTE LED FILET RETANGULAR/CALHA 3000K QUENTE 23W 110V 106X4CM QUANT =1 | —S                       | INTERRUPTOR DE 01 SECÇÃO h=1.20m DO PISO  |
| 2                 | AR 70 DE SOBREPOR 10,5X11,5X11,5 QUANT = 3                                 | —SS                      | INTERRUPTOR DE 02 SECÇÕES h=1.20m DO PISO |
| 3                 | PAR 20 DE SOBREPOR 11X11,8X11,8 QUANT = 3                                  | —SSS                     | INTERRUPTOR DE 03 SECÇÕES h=1.20m DO PISO |

Executivo

PLANTA DE PONTOS DE INTERRUPTORES

Descrição: Planta de Ponto de Interruptores

Data: 05/06/ 2020

Escala: 1 : 20

Prancha:

10/ 1

| LEGENDA PONTOS ELÉTRICOS |  |
|--------------------------|--|
|                          | TOMADA MÉDIA DE 100W h= 1.20m DO PISO  |
| 20a                      | TOMADA MÉDIA DE 20 AMPERES h= 1.20m DO PISO  |
| 20a                      | TOMADA ALTA DE 20 AMPERES h= 2.00m DO PISO   |
| 20a                      | PONTO DE TOMADA TETO DE 20 AMPERES   |
|                          | PONTO DE TOMADA PISO (DEIXAR FIO ESTENDIDO PARA EMBUTIR NA MARCENARIA)               |
| 20a                      | PONTO DE TOMADA PISO DE 20 AMPERES (DEIXAR FIO ESTENDIDO PARA EMBUTIR NA MARCENARIA) |

| LEGENDA PONTOS HIDRÁULICOS |                    |
|----------------------------|--------------------|
|                            | PONTO DE ÁGUA FRIA |
|                            | PONTO DE ESGOTO    |

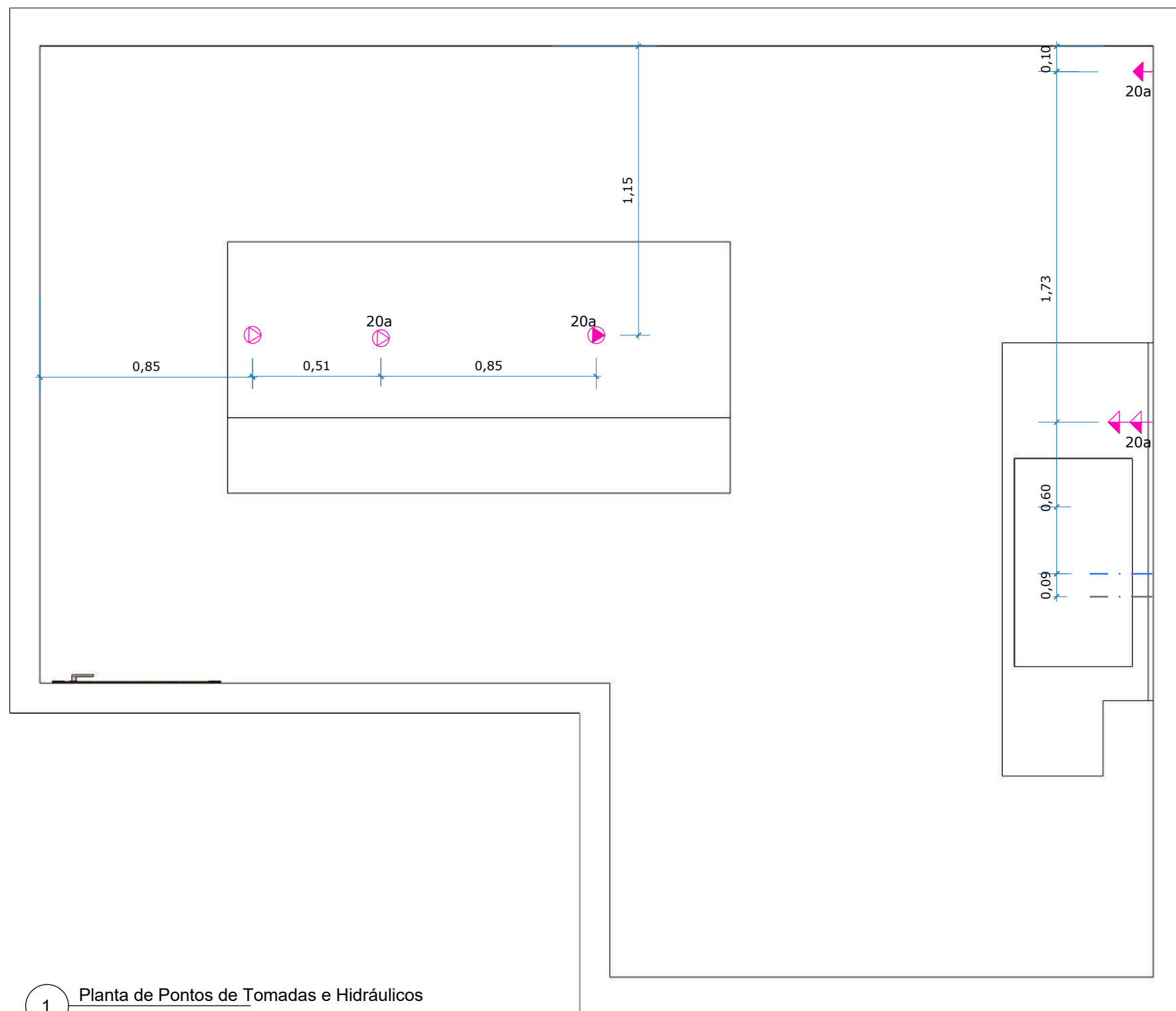

1 Planta de Pontos de Tomadas e Hidráulicos  
 ESCALA: 1 : 20

**Executivo** PLANTA DE PONTOS DE TOMADAS E HIDRÁULICOS

Descrição: Planta de Pontos de Tomadas e Hidráulicos

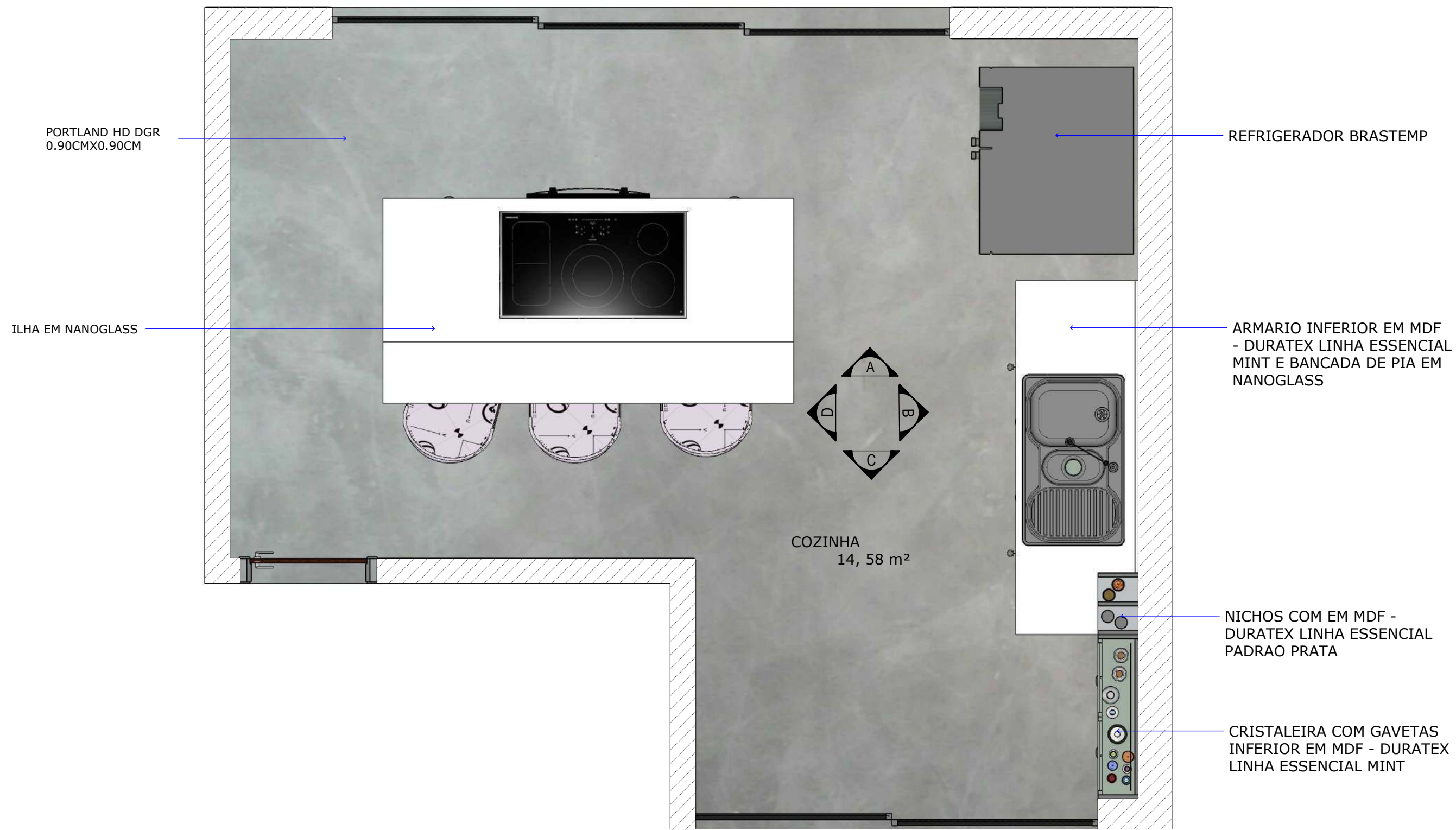

1 Planta Baixa  
ESCALA: 1 : 20

Executivo

PLANTA BAIXA

Descrição: Planta Baixa

----

----

Data: 05/06/ 2020

Escala: 1 : 20

Prancha:

12/ 1



1 Vista A  
 ESCALA: 1 : 20

Executivo

VISTA A

Descrição: Vista A

Data: 05/06/ 2020

Escala: 1 : 20

Prancha:

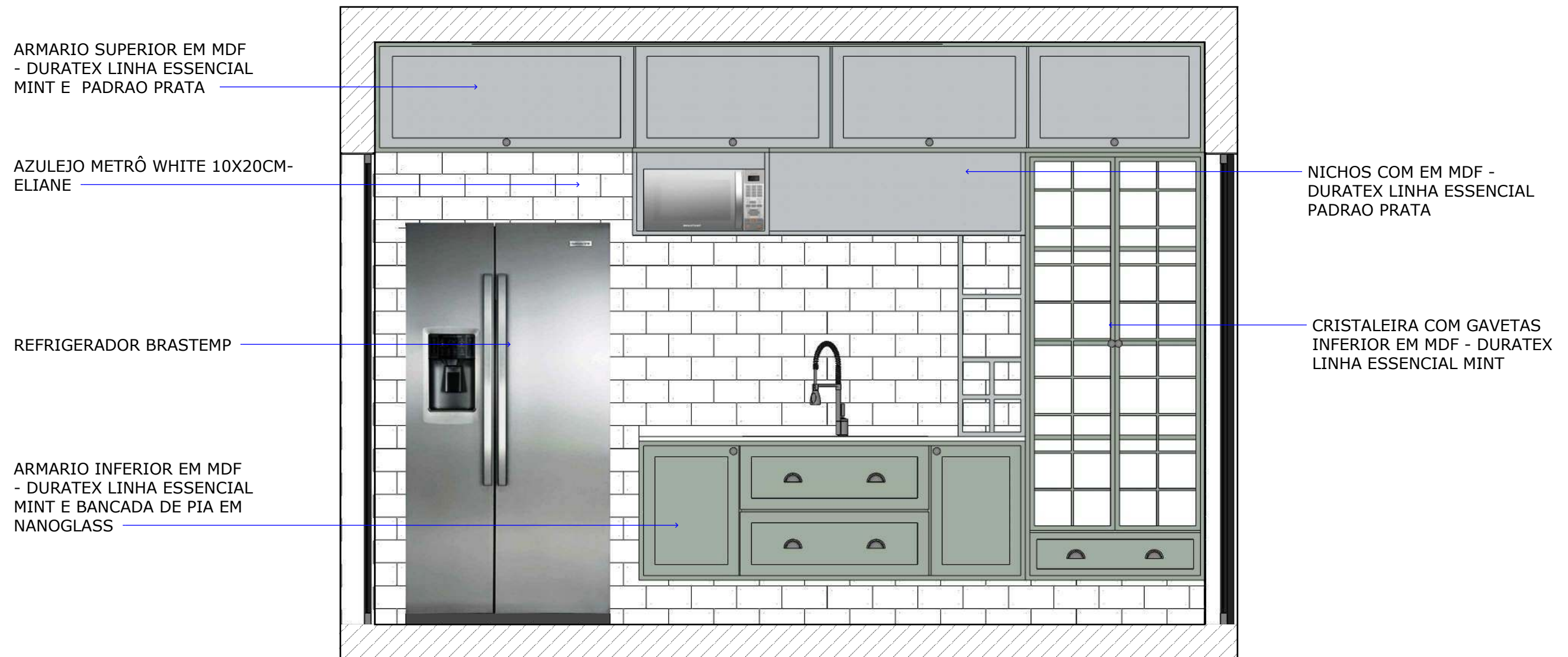

1 Vista B  
 ESCALA: 1 : 20

**Executivo**

VISTA B

Descrição: Vista B

----

----

Data: 05/06/ 2020

Escala: 1 : 20

Prancha:

**14/ 1**

ARMARIO SUPERIOR EM MDF  
- DURATEX LINHA ESSENCIAL  
MINT E PADRAO PRATA

REFRIGERADOR BRASTEMP



COIFA MERIDIANA ED S ELICA

PRATELEIRAS COM MDF E APOIO  
EM METALON

ILHA EM NANOGLASS E ARMARIO  
EM MDF LINHA ESSENCIAL MINT -  
DURATEX COM FORNO EMBUTIDO

1 Vista C  
ESCALA: 1 : 20

Executivo

VISTA C

Descrição: Vista C

----

----

Data: 05/06/ 2020

Escala: 1 : 20

Prancha:

15/ 1

AZULEJO METRÔ WHITE 10X20CM-ELIANE

BANQUETA ELDORADO



PAREDE COM REVESTIMENTO EM CIMENTO QUEIMADO

CONJUNTO DE QUADROS DE TEMPERO

COIFA BRASTEMP COM PRATELEIRAS DE APOIO

ILHA DE NANOGLASS

1 Vista D  
ESCALA: 1 : 20

Executivo

VISTA D

Descrição: Vista D

Data: 05/06/ 2020

Escala: 1 : 20

Prancha:

16/ 1



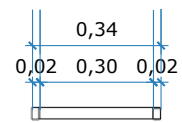

Vista Superior

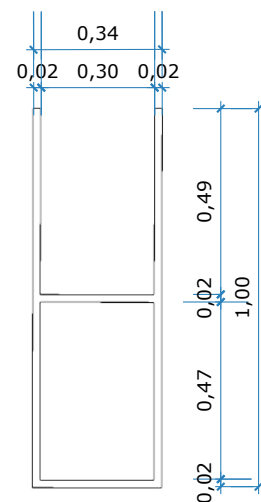

Vista Frontal

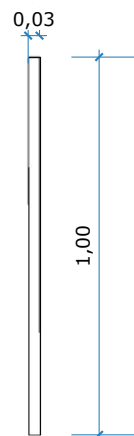

Vista Lateral

SUPORTE DE METALON  
NA COR PRATA

ALTURA = 1.00 M  
PROFUNDIDADE = 0.03 M  
COMPRIMENTO = 0.34 M

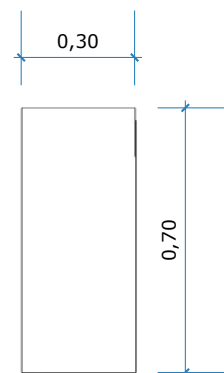

Vista Superior

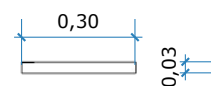

Vista Frontal

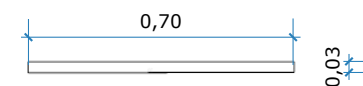

Vista Lateral

PRATELEIRA

ALTURA = 0.03 M  
PROFUNDIDADE = 0.70 M  
COMPRIMENTO = 0.30 M

MDF = LINHA ESSENCIAL  
MINT DURATEX

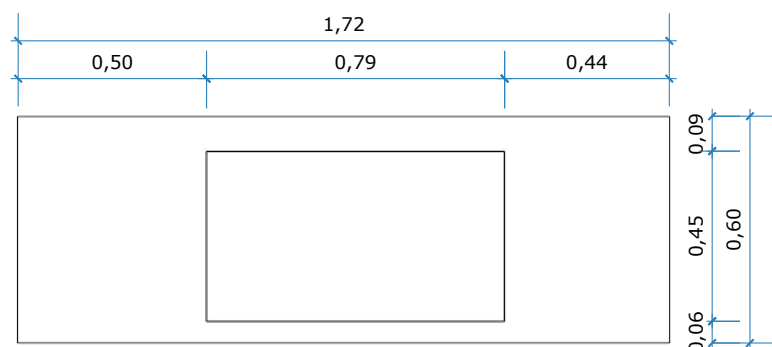

Vista Superior

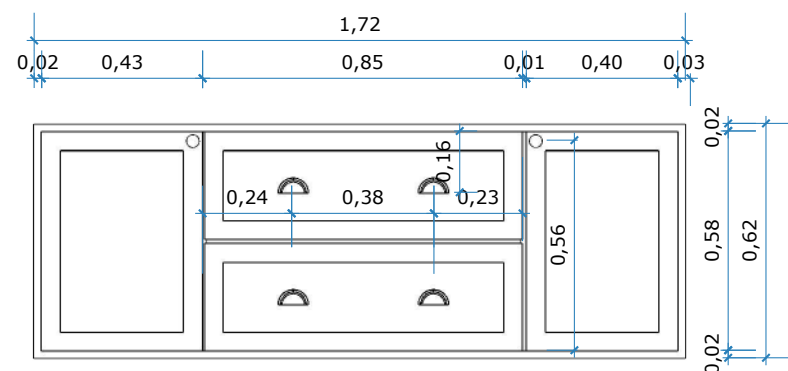

Vista Frontal

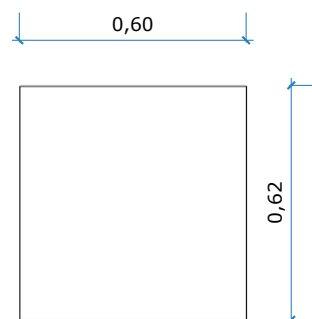

Vista Lateral

ARMARIO INFERIOR

ALTURA = 0.62 M  
PROFUNDIDADE = 0.60 M  
COMPRIMENTO = 1.72 M  
PUXADOR = CONCHA E PONTO  
NA COR PRATA

MDF = LINHA ESSENCIAL  
MINT - DURATEX

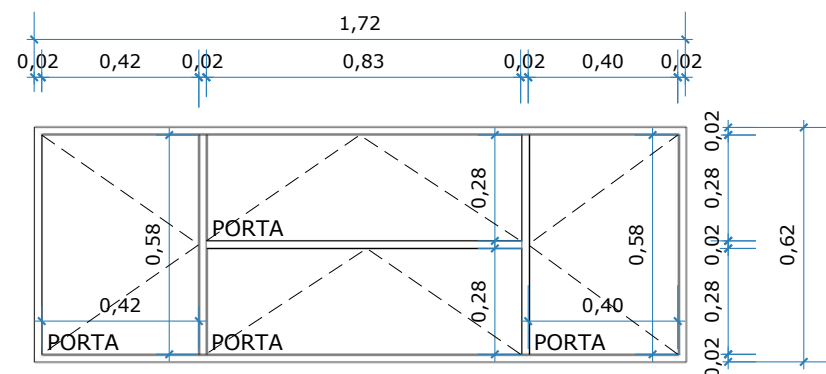

Vista Frontal

Executivo

DETALHE MARCENARIA

Descrição: Detalhamento de Marcenaria

Data: 05/06/ 2020

Escala: 1 : 20

Prancha:

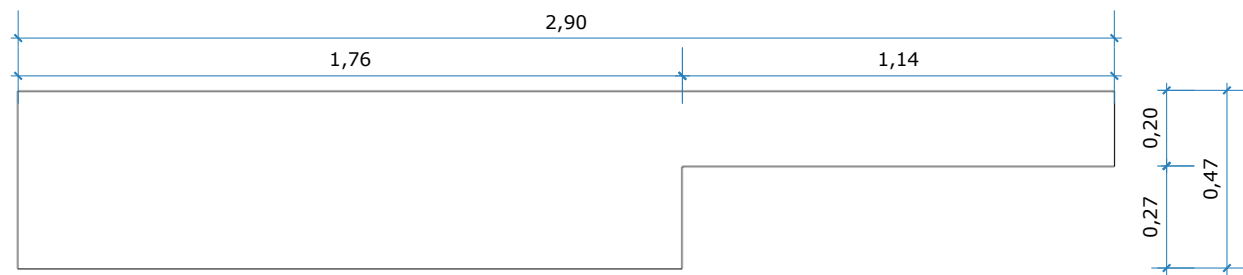

Vista Superior

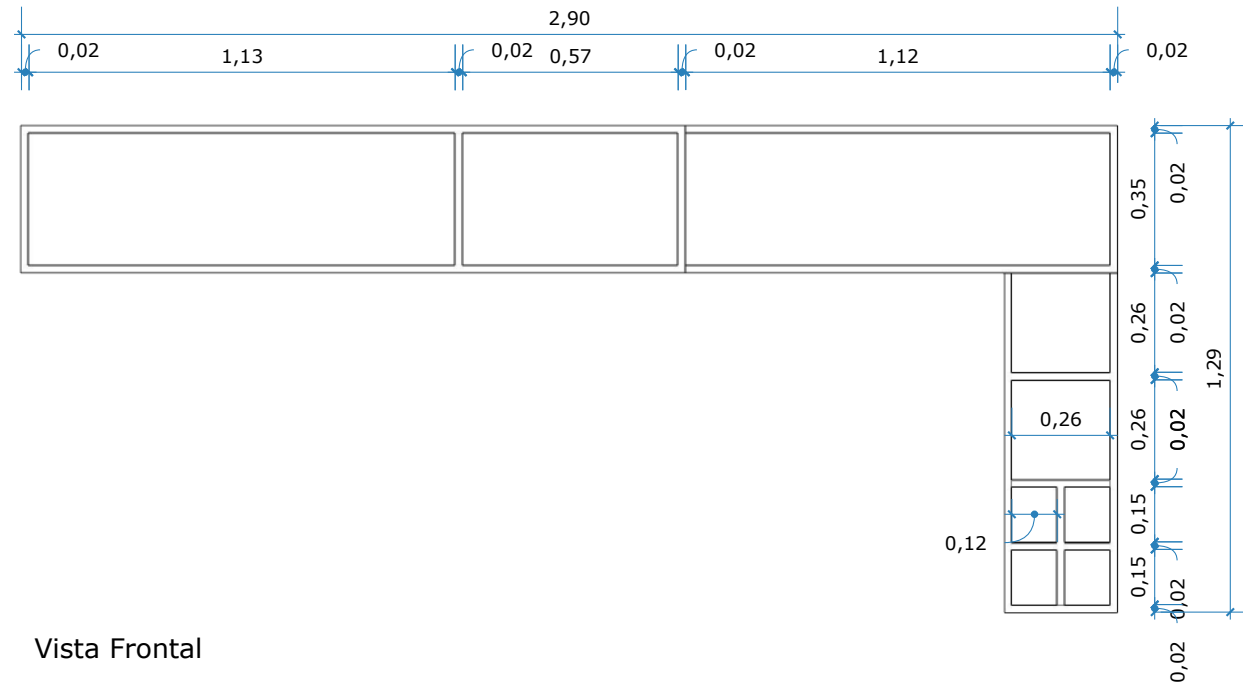

Vista Frontal

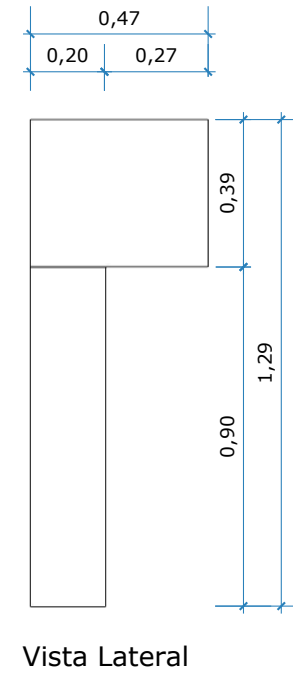

Vista Lateral

NICHOS

ALTURA = 1.29 M  
 PROFUNDIDADE = 0.47 M  
 COMPRIMENTO = 2.90 M

MDF = LINHA ESSENCIAL  
 PADRAO PRATA - DURATEX

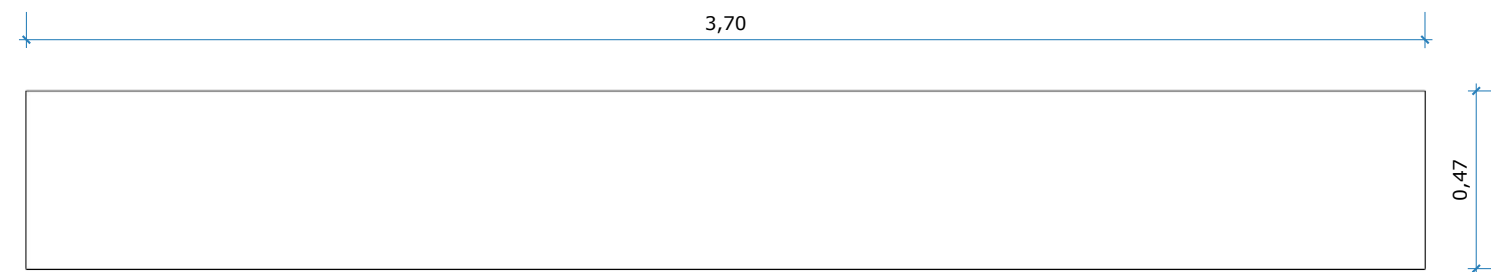
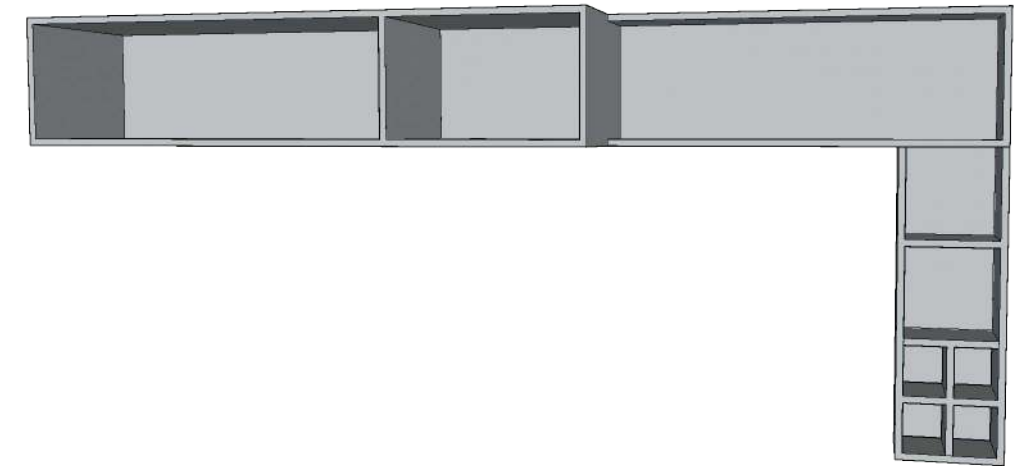

Vista Superior

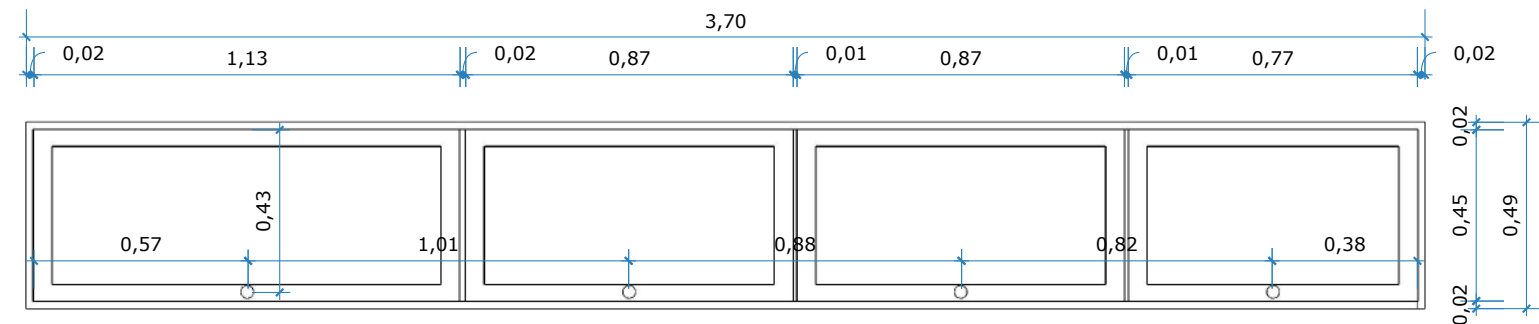

Vista Frontal

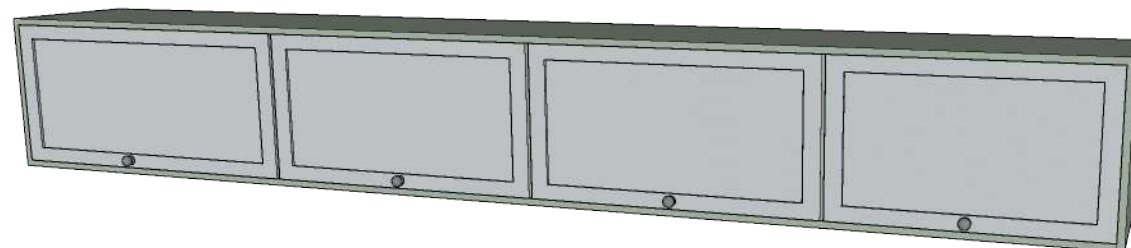

ARMARIO SUPERIOR

ALTURA = 0.49 M  
 PROFUNDIDADE = 0.47 M  
 COMPRIMENTO = 3.70 M  
 PUXADOR = PONTO NA COR PRATA

MDF = LINHA ESSENCIAL  
 MINT - DURATEX

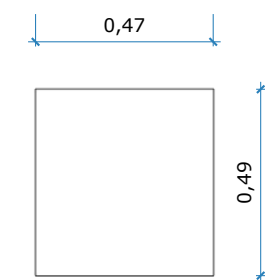

Vista Lateral

Executivo

DETALHE MARCENARIA

Descrição: Detalhamento de Marcenaria

----

----

Data: 05/06/ 2020

Escala: 1 : 20

Prancha:

## CRISTALEIRA

ALTURA = 1.91 M  
PROFUNDIDADE = 0.20 M  
COMPRIMENTO = 0.80 M  
PUXADOR = CONCHA NA COR PRATA

MDF = LINHA ESSENCIAL MINT - DURATEX  
VIDRO REFLECTA BRONZE

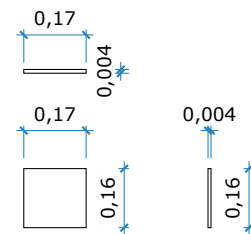
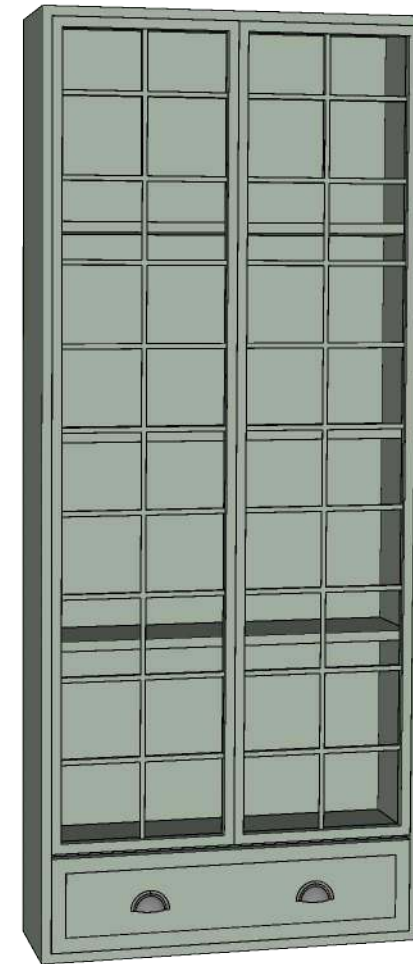
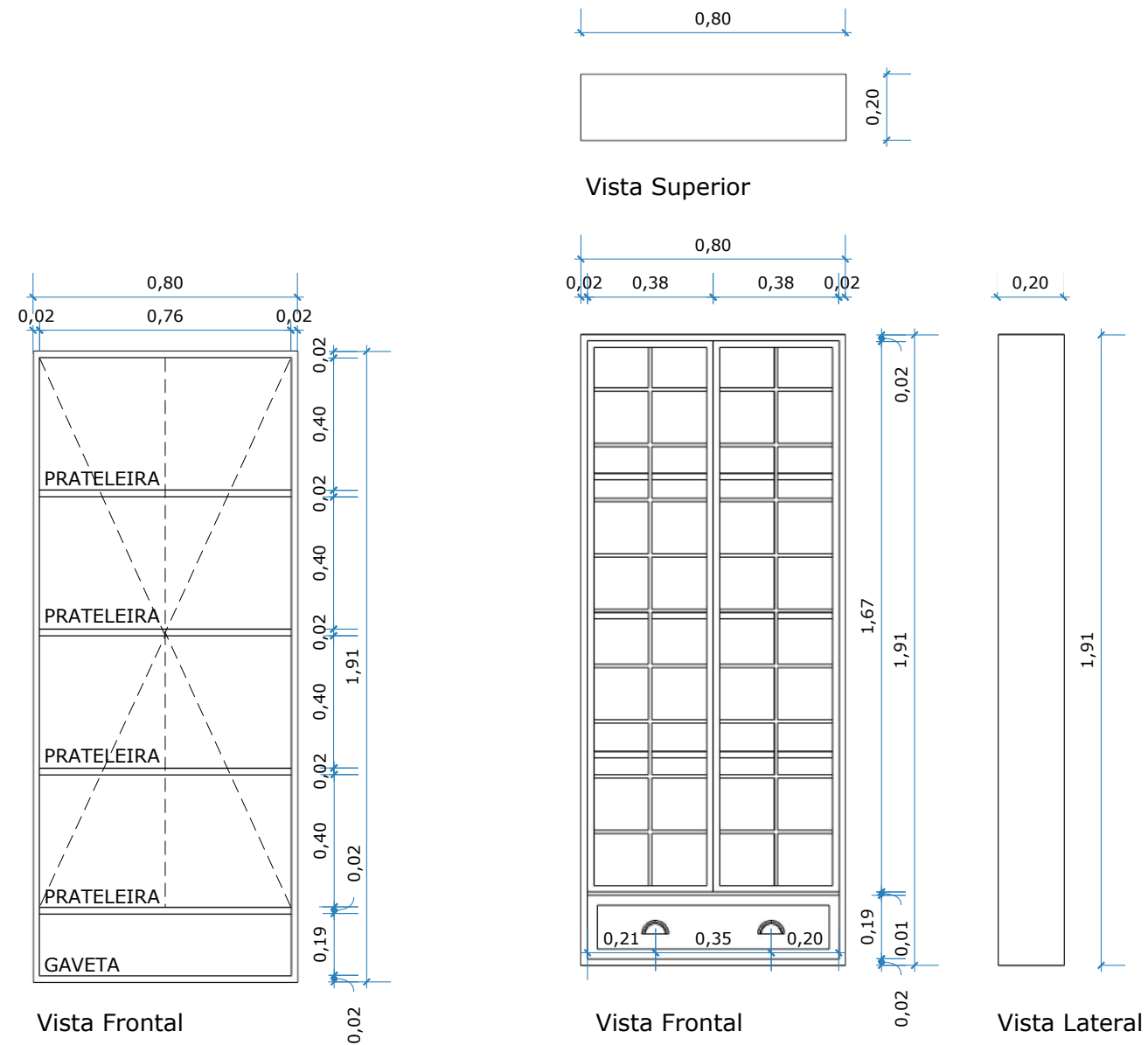

### VIDRO (36 UNIDADES)

ALTURA = 0.16 M  
PROFUNDIDADE = 0.004 M  
COMPRIMENTO = 0.17 M  
VIDRO REFLECTA BRONZE

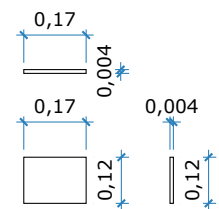

### VIDRO (4 UNIDADES)

ALTURA = 0.16 M  
PROFUNDIDADE = 0.004 M  
COMPRIMENTO = 0.17 M  
VIDRO REFLECTA BRONZE

## Executivo

## DETALHE MARCENARIA

Descrição: Detalhamento de Marcenaria

Data: 05/06/ 2020

Escala: 1 : 20

Prancha:

19/ 1

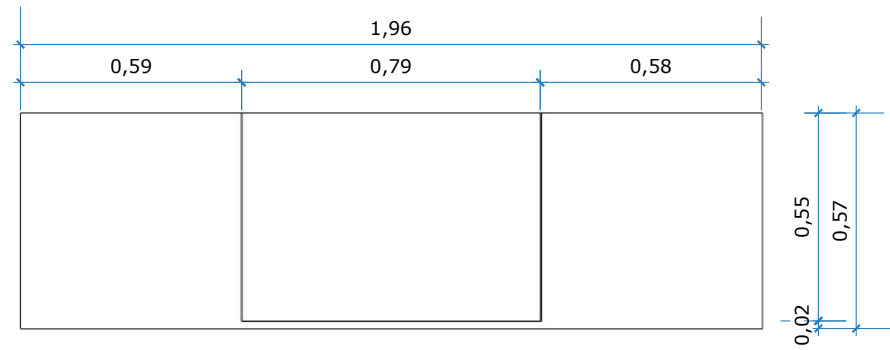

Vista Superior

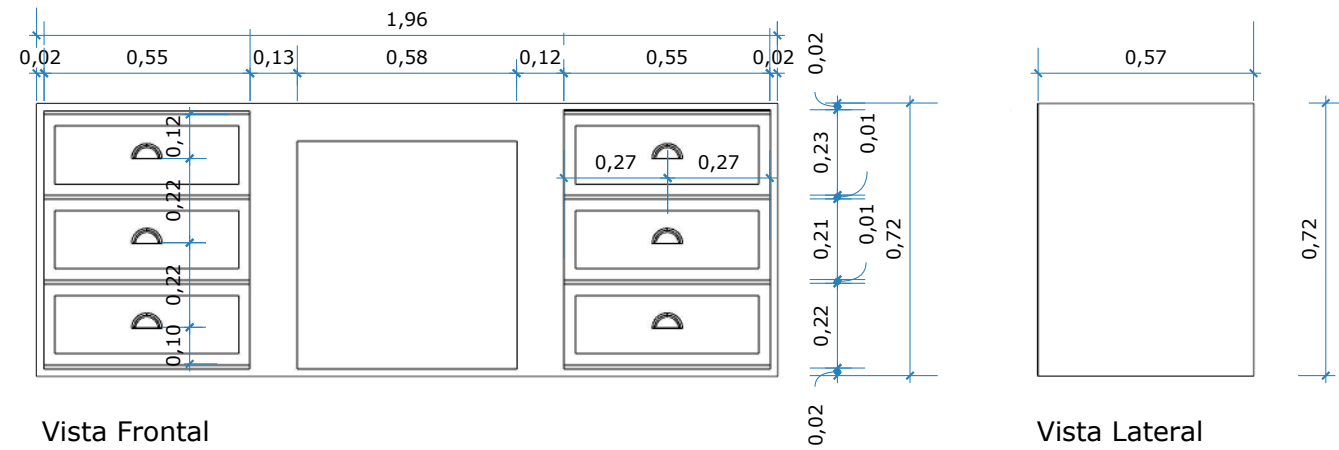

Vista Frontal

Vista Lateral

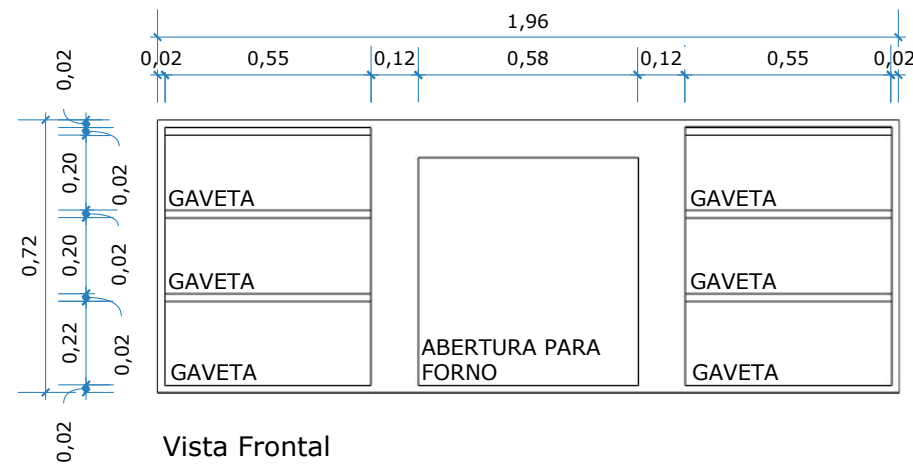

Vista Frontal

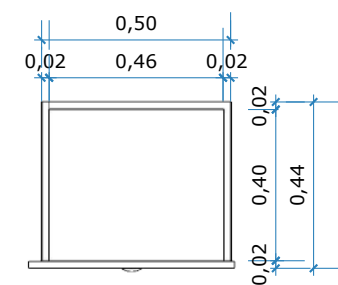

Vista Superior

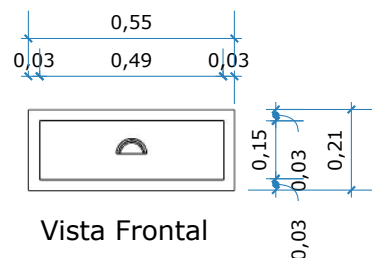

Vista Frontal

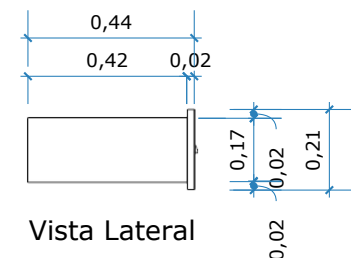

Vista Lateral

GAVETA DE ARMARIO DE ILHA

ALTURA = 0.21 M  
 PROFUNDIDADE = 0.44 M  
 COMPRIMENTO = 0.55 M  
 PUXADOR = CONCHA NA COR PRATA  
 MDF = LINHA ESSENCIAL MINT - DURATEX

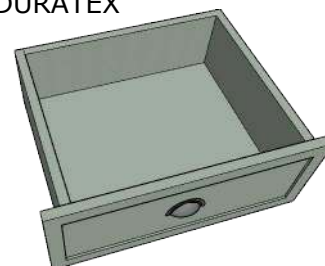

ARMARIO DE ILHA

ALTURA = 0.72 M  
 PROFUNDIDADE = 0.57 M  
 COMPRIMENTO = 1.96 M

MDF = LINHA ESSENCIAL MINT - DURATEX

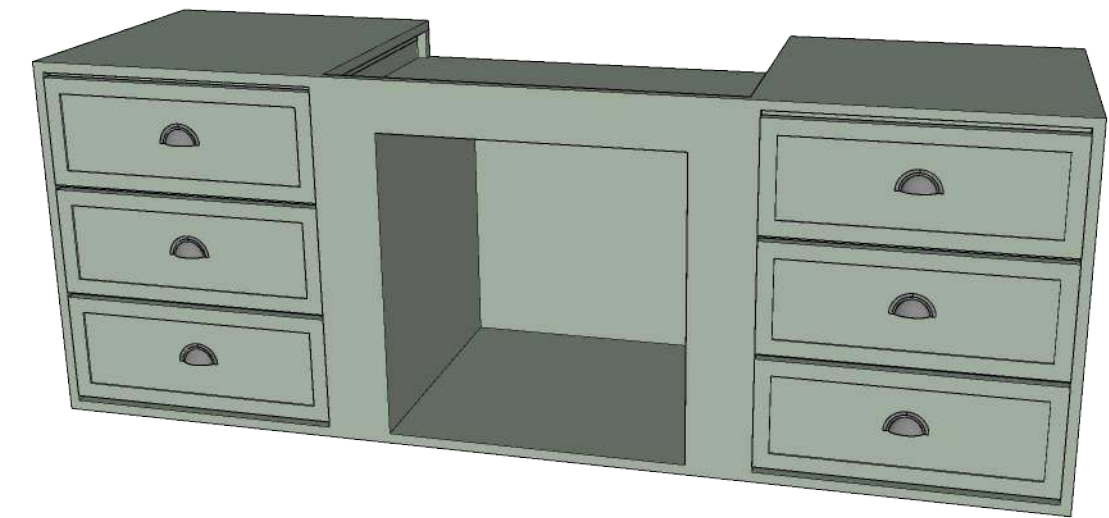

Executivo

DETALHE MARCENARIA

Descrição: Detalhamento de Marcenaria

Data: 05/06/ 2020

Escala: 1 : 20

Prancha:

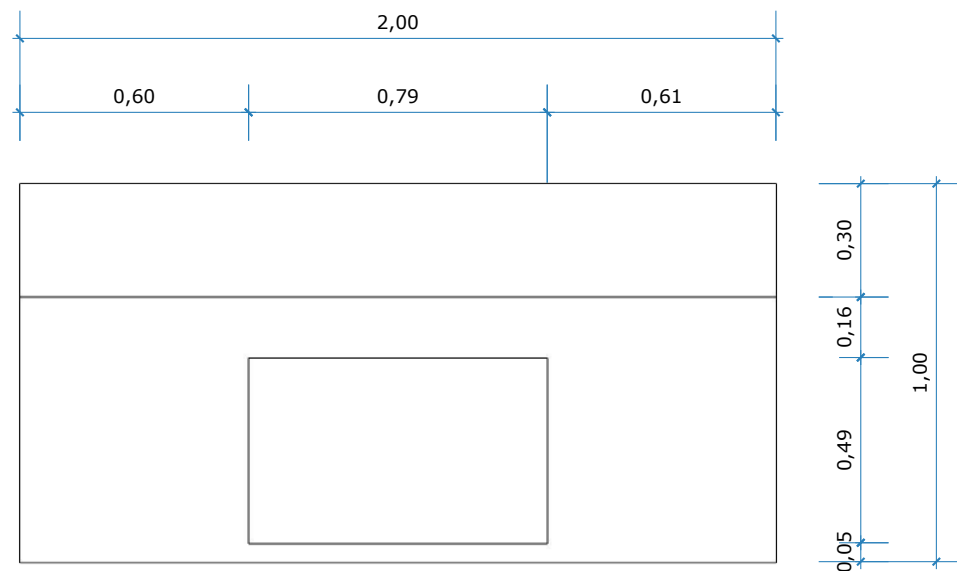

Vista Superior

ILHA DE NANOGLASS

ALTURA = 0.98 M  
 PROFUNDIDADE = 0.05 M  
 COMPRIMENTO = 3.71 M  
 ESPESURRA = 0.02 M

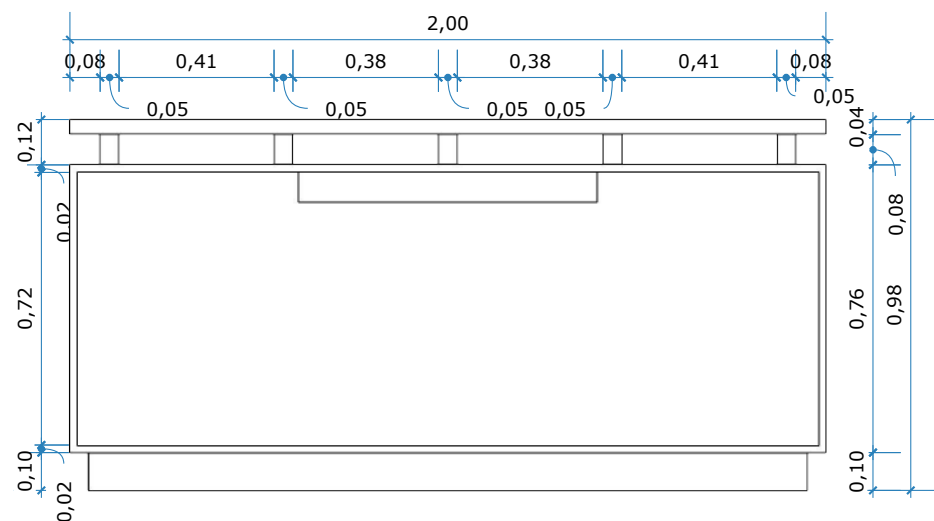
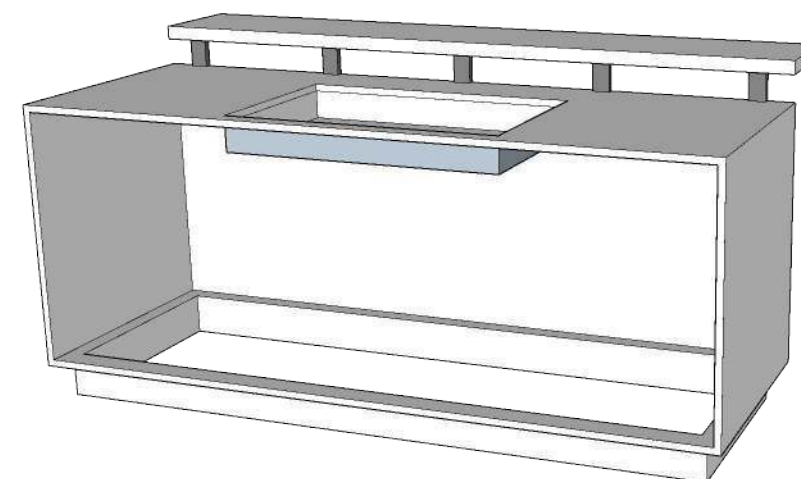

Vista Frontal

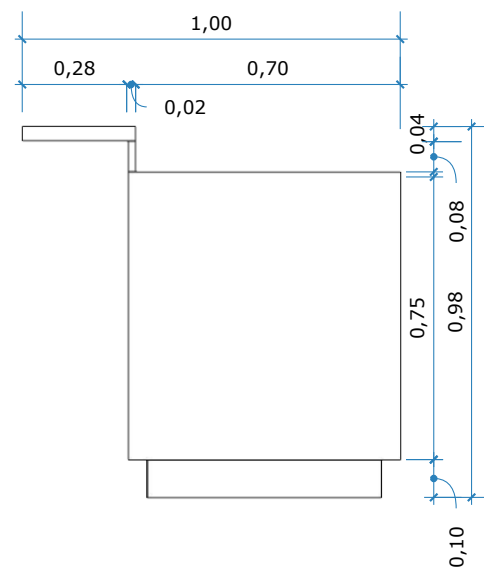

Vista Lateral

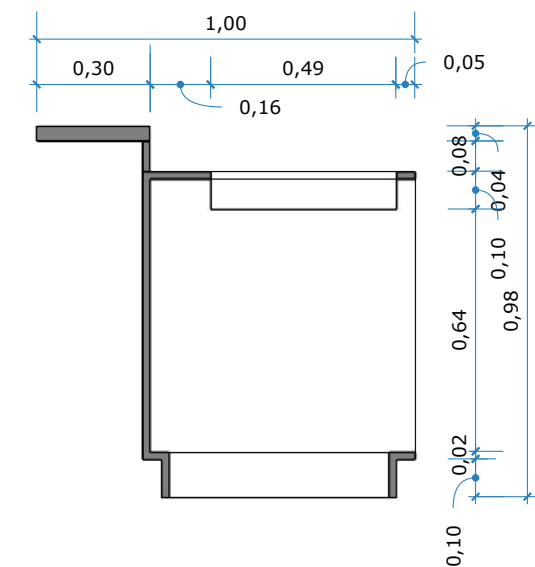

Corte Lateral

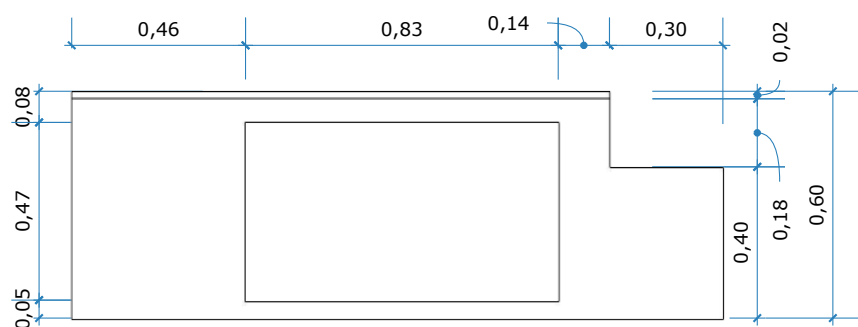

Vista Superior

BANCADA DE APOIO EM NANOGLASS

ALTURA = 0.06 M  
 PROFUNDIDADE = 0.60 M  
 COMPRIMENTO = 1.72 M

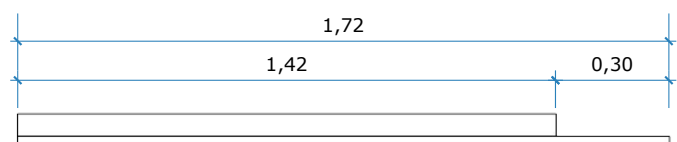
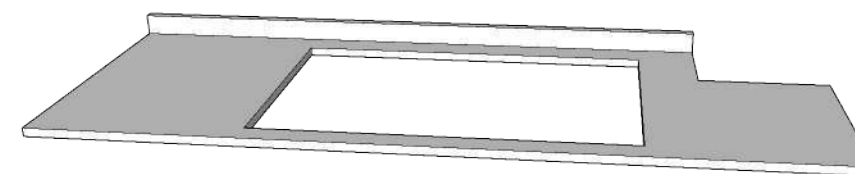

Vista Frontal

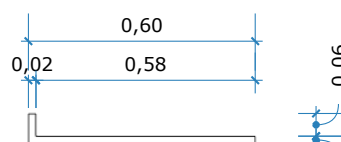

Vista Lateral

Executivo

DETALHE MARMORARIA

Descrição: Detalhamento de Marmoraria

Data: 05/06/ 2020

Escala: 1 : 20

Prancha: